

BARRE FILETTATE GEOTECNICA E MICROPALI

Sinistrorsa, laminata a caldo

B500 diam. 12 - 50

S555/700 diam. 63,5

CONTINUOUS THREADED BAR - CT BAR

Hot rolled, ribbed – left hand thread

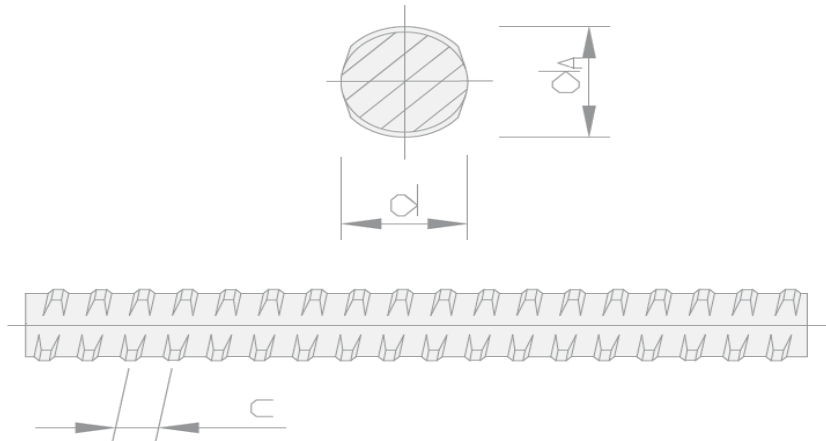

d mm	12	16	20	25	28	32	40	50	63,5
d _A mm	14	19	23	29	32	36	45	56	70
c mm	7	8	10	12,5	14	16	20	26	21
f _y /f _t /A ₁₀ ¹⁾	500 N/mm ² 550 N/mm ² ≥ 10%								555 N/mm ² 700 N/mm ² ≥ 10%
F _y (F _{0,2}) kN	57	100	160	245	310	405	630	980	1760
F _t kN	62	110	175	270	340	440	690	1080	2215
F _{y/1,75} kN	32	57	91	140	177	231	360	560	1000
A mm ²	113	201	314	491	616	804	1260	1960	3167
G kg/m	0,89	1,58	2,47	3,85	4,83	6,31	9,87	15,4	24,86

f_y = tensione di snervamento minima / minimum yield stress

f_t = tensione di rottura minima / minimum break stress

A₁₀ = allungamento a rottura su base 10 diametri / extensibility on 10 diameter bases

F_t = carico di rottura minimo / minimum break load

F_y = carico di snervamento minimo / minimum yield load

A = area / area