

## BARRA A FILETTATURE CONTINUA - S670

Destrosa, laminata a caldo

## CONTINUOUS THREADED BAR - CT BAR S670

Hot rolled, ribbed – right hand thread

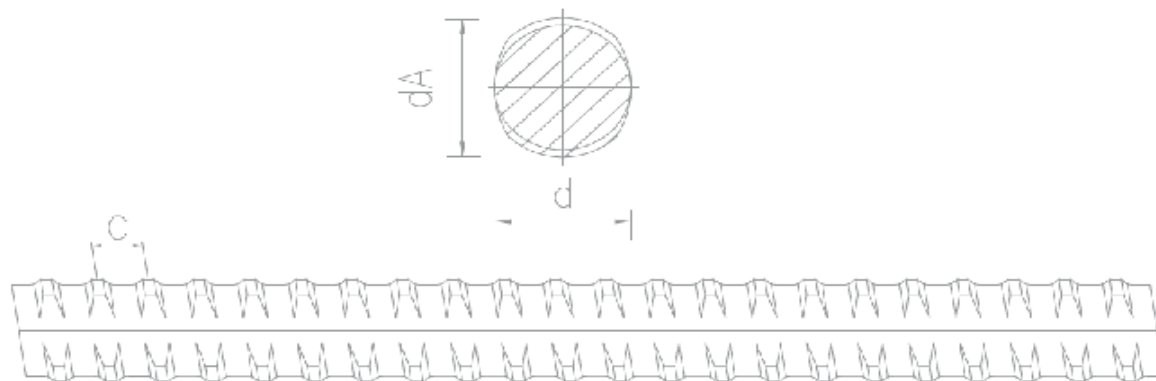

d mm	18	22	25	28	30	35	43	57,5	63,5
d <sub>A</sub> mm	21	25	28	32	34	40	48	63	70
c mm	8	8	10	11	1	14	7	20	21
f <sub>y</sub> /f <sub>t</sub> /A <sub>10</sub> <sup>1)</sup>	670 N/mm <sup>2</sup>		800 N/mm <sup>2</sup>		≥ 10%				
F <sub>y</sub> (F <sub>0,2</sub> ) kN	170	250	330	410	75	640	980	1740	2120
F <sub>t</sub> kN	195	300	390	490	565	770	1170	2080	2540
F <sub>y</sub> /1,75 kN	97	142	188	234	271	365	560	994	1211
A mm <sup>2</sup>	250	375	491	616	707	962	1466	2597	3167
G kg/m	1,96	2,94	3,85	4,83	5,55	7,55	11,51	20,38	24,86

f<sub>y</sub> = tensione di snervamento minima / minimum yield stress

f<sub>t</sub> = tensione di rottura minima / minimum break stress

F<sub>y</sub> = carico di snervamento minimo / minimum yield load

F<sub>t</sub> = carico di rottura minimo / minimum break load

A<sub>10</sub> = allungamento a rottura su base 10 diametri / extensibility on 10 diameter bases

A = area / area